

REV	LOCATIONS	DESCRIPTION	DATE	REVISER	APPD
1	▲	Add buckle points	07/AUG/24	MATT	LEO

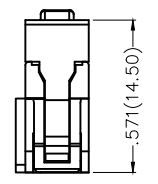
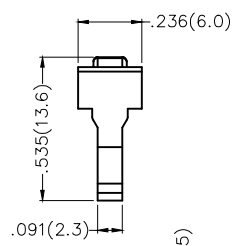
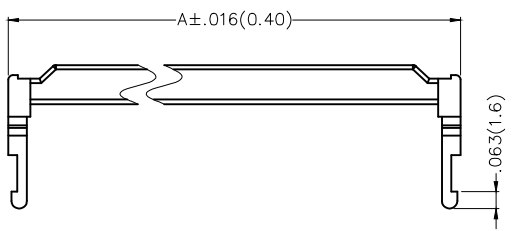

Assemble

SPECIFICATIONS

Electrical

Current Rating: 1.0A AC(rms)/DC  
Voltage Rating: 250V AC(rms)/DC  
Contact Resistance: 20 mΩ Max  
Insulation Resistance: 1000 MΩ Min  
Withstanding Voltage: 500V AC r.m.s  
Temperature Range—Operating: -40°C~+105°C

Material and Plating

Housing: PBT (UL94V-0)  
Contact: Brass  
Plating: Gold in contact area,  
nickel on tail

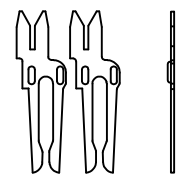
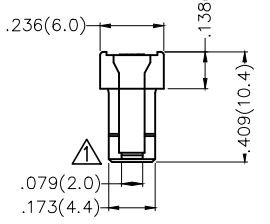
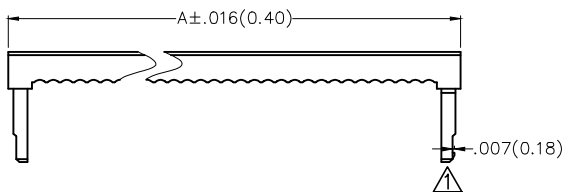

Terminal

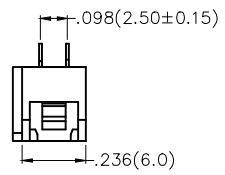
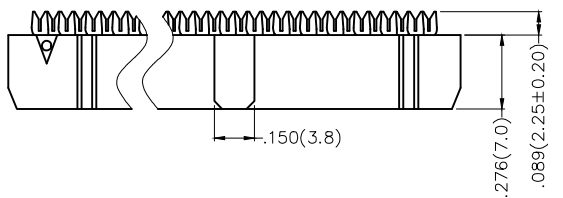

Ordering Information

FID 254 08 — XX 4 K6 K  
1 2 3 4 5 6 7

1 Category FID-IDC	2 Series Number 254-Pitch 2.54mm	3 Distinction No. 08	4 Circuits XX	5 Plating 4-Gold in contact area, nickel on tail	6 Plastic Coulor K6-Black	7 Packaging K-Tray
-----------------------	-------------------------------------	-------------------------	------------------	---	------------------------------	-----------------------

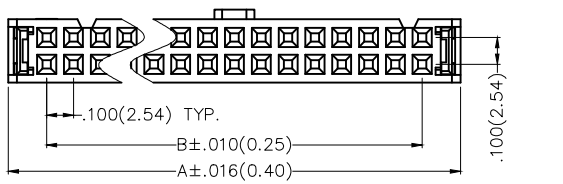

14P~64P

Circuits (n)	Part No.	Dimensions(in/mm)	
		A	B
6	FID25408-064K6K	.485(12.32)	.200(5.08)
8	FID25408-084K6K	.585(14.86)	.300(7.62)
10	FID25408-104K6K	.685(17.40)	.400(10.16)
12	FID25408-124K6K	.785(19.94)	.500(12.70)
14	FID25408-144K6K	.885(22.48)	.600(15.24)
16	FID25408-164K6K	.985(25.02)	.700(17.78)
18	FID25408-184K6K	1.085(27.56)	.800(20.32)
20	FID25408-204K6K	1.185(30.10)	.900(22.86)
22	FID25408-224K6K	1.285(32.64)	1.000(25.40)
24	FID25408-244K6K	1.385(35.18)	1.100(27.94)

Circuits (n)	Part No.	Dimensions(in/mm)	
		A	B
26	FID25408-264K6K	1.485(37.72)	1.200(30.48)
30	FID25408-304K6K	1.685(42.80)	1.400(35.56)
34	FID25408-344K6K	1.885(47.88)	1.600(40.64)
36	FID25408-364K6K	1.985(50.42)	1.700(43.18)
40	FID25408-404K6K	2.185(55.50)	1.900(48.26)
44	FID25408-444K6K	2.385(60.58)	2.100(53.34)
50	FID25408-504K6K	2.685(68.20)	2.400(60.96)
60	FID25408-604K6K	3.185(80.90)	2.900(73.66)
64	FID25408-644K6K	3.385(85.98)	3.100(78.74)

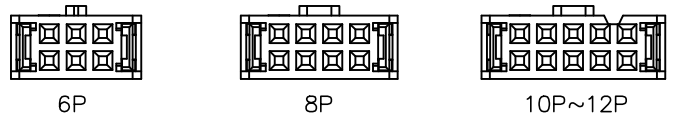
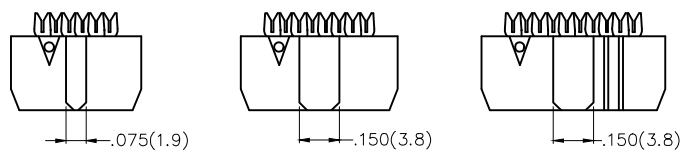

THIRD ANGLE PROJECTION	GENERAL TOLERANCES (UNLESS SPECIFIED)		APPROVE BY FRANK	DATE 18/JUN/13	PART NO. FID25408-XX4K6K	ITEM NO. FID25408	 Building Technology Cornerstone	
	DESIGN UNITS Inch (metric)	X.±.012(0.30)	X.±5'	CHECKED BY CHERRY	DATE 18/JUN/13	TITLE Wire to Board(IDC Connector) Pitch 2.54mm		REV 1
SCALE 5:1		SIZE A4	X.XX±.006(0.15)	.XX'±1"	DRAWN BY KATE	DATE 18/JUN/13	THIS DRAWING CONTAINS INFORMATION THAT IS PROPRIETARY TO TXGA INDUSTRIAL ELECTRONICS(S.Z)CO.,LTD AND SHOULD NOT BE USED WITHOUT WRITTEN PERMISSION	